

W3 Series

» Chain Block (W3 Series)

- **Austlift industrial** Grade W-3 series manually operated Chain Blocks are used for general hoisting operation such as mining, construction, industrial lifting and domestic applications.
- **Rated capacities** from 250kg to 20 tonne.
- **Standard height** of lift is 3 and 6 metre.
- **Other height** of lift available upon request. Manufactured for ease of operation, and light weight in design.
- **Robust, durable** and compact in construction.
- **All blocks** come with ball bearing Swivel Hook. Individually serial numbered with Test Certificate and instruction manual supplied.
- **Conforms** to AS1418.2 standards.



Please check operation manual for more details

Chain Blocks

Dimensions								
3M Chain Code	6M Chain Code	WLL Tonne	A mm	B mm	C mm	D mm	E mm	H MINI mm
111002	-	0.25	95	97	27	27	18	230
111005	111505	0.5	140	131	60	33	31	312
111010	111510	1	156	151	61	31	33	360
111015	111515	1.5	176	151	60	44	38	385
111020	111520	2	223	183	67	58	40	430
111025	111525	3	223	151	106	85	44	490
111030	111530	5	252	183	133	64	49	675
111035	111535	10	380	183	263	88	64	880
111040	111540	15	420	230	310	95	80	950
111045	111542	20	480	320	580	100	95	1075

3M Chain Code	6M Chain Code	WLL (T)	Test Load (T)	Pulling Effort (Kg)	Load Chain Size (mm)	No. of chain falls	Net Weight (Kg)	Extra Weight/M Extra Lift (Kg)	Packaging Dimensions (cm)
111002	-	0.25	0.32	≤25	4	1	3	1.5	22x17x23
111005	111505	0.5	0.63	≤27	5	1	8.2	1.5	22x17x23
111010	111510	1	1.25	≤31.5	6	1	11.3	1.8	24x18x23
111015	111515	1.5	1.88	≤36	7.1	1	13.2	2	26x18x26
111020	111520	2	2.5	≤40	8	1	21.3	2.7	32x20x29
111025	111525	3	3.75	≤47.5	7.1	2	21.7	3.2	31x18x33
111030	111530	5	7.5	≤48	9	2	39.7	5.3	40x20x36
111035	111535	10	12.5	≤49.5	9	4	66	9.8	54x50x31
111040	111540	15	18.75	≤45.6	10	6	95	14.2	55x60x40
111045	111542	20	25	≤44.7	10	8	155	23.9	60x70x50

* Other chain length available.(111541 15Tx10M, 111544 20Tx9M.)



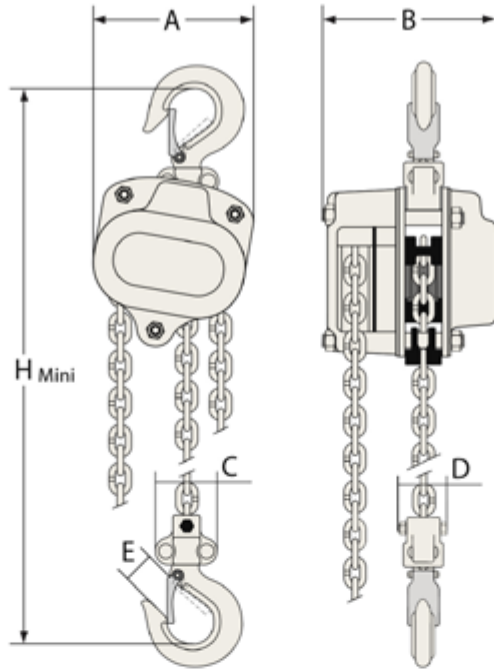

WLL: 0.5T, 1T, 1.5T, 2T

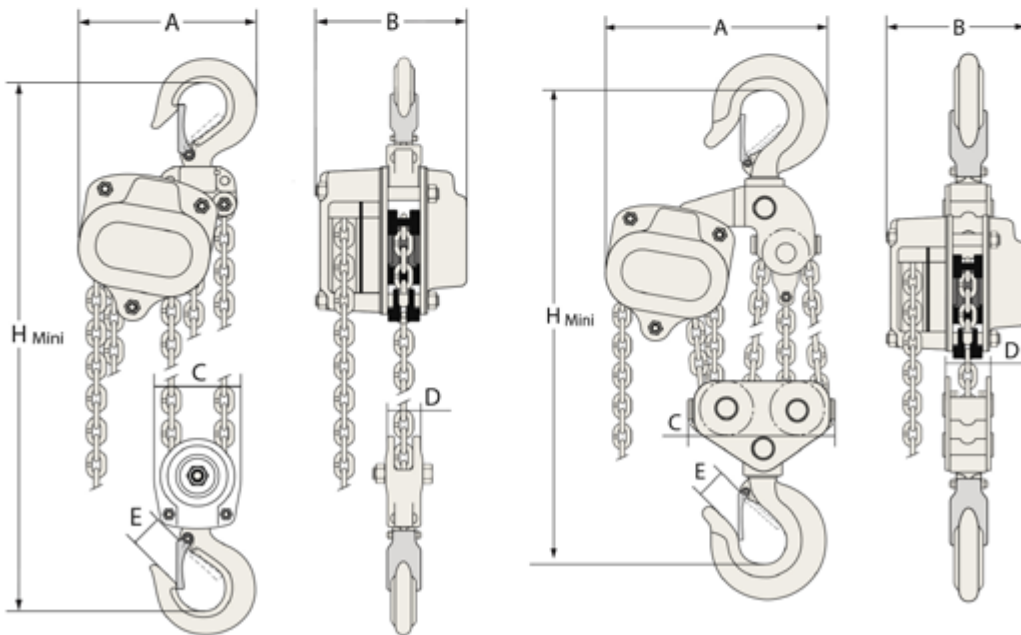

WLL: 3T, 5T

WLL: 10T, 15T, 20T