



## TiTAN G80 EYE SELF LOCKING HOOKS WITH GRIP LATCH



### FEATURES

- Will remain closed until the quick release trigger is pressed
- Once opened the hook will remain open until load is engaged
- Large eye to enable assembling to wire rope (thimble)
- Flat section on eye for attaching Omega links
- Yellow powder plastified finish
- Special grip latch in forging for additional secure closing and safety
- Complies with AS3776/EN1677
- Fatigue tested at 1.5 x WLL for 20000 cycles
- 100% Magnaflux crack detection
- Test certificates available
- Individually proof tested

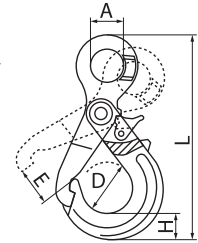

Code	Weight (kg)	WLL (t)	Dimensions (mm)				
			A	H	E	L	D
T077ESLHGL-7/8	0.75	2	25	21.5	34	163	40
T077ESLHGL-10	1.2	3.2	32	26.2	42	201.5	50
T077ESLHGL-13	2	5.3	40	31	50	243.5	60
T077ESLHGL-16	4.1	8	50	39.5	60	298	70

## TiTAN G80 SWIVEL SELF LOCKING HOOKS WITH GRIP LATCH (NO BEARING)



### FEATURES

- Will remain closed until the quick release trigger is pressed
- Once opened the hook will remain open until load is engaged
- Large eye swivel for easy assembly to wire rope (thimbles)
- Flat section on swivel eye for attaching Omega links
- 100% Magnaflux crack detection
- Special grip latch in forging for additional secure closing and safety
- Complies with AS3776/EN1677
- Fatigue tested at 1.5 x WLL for 20000 cycles
- Yellow powder plastified finish
- Test certificates available
- Individually proof tested

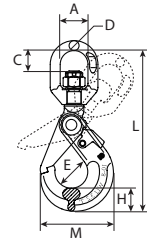

Code	Weight (kg)	WLL (t)	Dimensions (mm)						
			A	C	D	H	E	L	M
T343SSLHGL-6	0.68	1.1	32.5	23	11	19.5	39	176	76
T343SSLHGL-7/8	0.97	2	35.5	26	12.5	21.5	40	193.5	83
T343SSLHGL-10	1.83	3.2	42	33	15	26.5	50	233	101
T343SSLHGL-13	3.3	5.3	50	39	18	30.5	60	273	121

## TiTAN G80 SWIVEL SAFETY HOOK WITH CAST LATCH (NO BEARING)



### FEATURES

- Large eye swivel for easy assembly to wire rope (thimbles)
- Flat section on eye to enable assembly to Omega links
- Individually proof tested
- Heavy duty cast safety latch
- Spare latch kits available
- Complies with AS3776/EN1677
- Fatigue tested at 1.5 x WLL for 20000 cycles
- 100% Magnaflux crack detection
- Yellow powder plastified finish
- Test certificates available

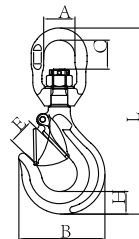

Code	Weight (kg)	WLL (t)	Dimensions (mm)					
			A	B	R	H	C	L
T268SSH-7/8	0.85	2	36	88.5	27	23.5	26	190
T268SSH-10	1.54	3.2	42	104.5	32	29.5	34	233
T268SSH-13	3.04	5.3	49	135	40	38	41	291.5
T268SSH-16	5.36	8	61	161	45	45.4	53	352

